

CONCEPTUAL PLANS  
-NOT FOR CONSTRUCTION-  
-NOT FOR BID  
NOT FOR PERMITTING

## LEGEND

- XS — EXISTING SEWER MAIN  
— XS — EXISTING SEWER LATERAL  
— SEWER — PROPOSED SEWER LATERAL  
C.O. CLEANOUT  
— WCK — EXISTING WATER MAIN  
— CW — PROPOSED WATER SERVICE

## NOTES:

- THE LOCATION, SIZE AND MATERIAL OF THE EXISTING FACILITIES, UTILITIES, AND TOPOGRAPHY HAVE BEEN RECORDED FROM THE MOST RELIABLE INFORMATION AVAILABLE TO THE ENGINEER. THIS INFORMATION IS NOT GUARANTEED. CONTRACTOR SHALL VERIFY EXISTING AND PROPOSED ELEVATIONS, EXISTING AND PROPOSED HORIZONTAL LOCATIONS AND VERTICAL ELEVATIONS, AND DEPTH, OF ALL UTILITIES INCLUDING INVERTS AND SLOPES, SIZE, MATERIAL TYPE, CONDITION, DIAMETER, CONFLICTS, ETC., AND REPORT ANY DISCREPANCIES TO THE ENGINEER, PRIOR TO THE START OF CONSTRUCTION. THE ENGINEER ASSUMES NO RESPONSIBILITY FOR THE ACCURACY OF THE FACILITIES, UTILITIES, AND TOPOGRAPHY SHOWN OR NOT SHOWN. IT IS THE RESPONSIBILITY OF THE CONTRACTOR TO VERIFY THROUGH VACUUM EXTRACTION AND TEST HOLE (POT HOLE) METHODS, THE ELEVATIONS AND LOCATIONS OF ALL EXISTING FACILITIES SHOWN OR NOT SHOWN PRIOR TO ORDERING MATERIAL AND PRIOR TO BEGINNING CONSTRUCTION, SUFFICIENTLY AHEAD OF HIS CONSTRUCTION SCHEDULE. ANY AND ALL CONFLICTS WITH EXISTING FACILITIES SHALL BE REPORTED TO THE ENGINEER SUFFICIENTLY AHEAD OF CONSTRUCTION, TO ALLOW THE ENGINEER AMPLIFIED RE-DESIGN TIME AND RE-PERMITTING TIME (20 WORKING DAYS). CONTRACTOR'S SUPPLIED INFORMATION SHALL BE IN AUTOCAD 2010 FORMAT WITH HORIZONTAL AND VERTICAL INFORMATION OF ALL UTILITIES USING THE ENGINEER'S AUTOCAD PLANS AND SURVEYOR'S SURVEY. CONTRACTOR SHALL SPOT-DIG AND LOCATE EXISTING UTILITIES AS DIRECTED BY THE ENGINEER, AT NO ADDITIONAL COST, IF AND WHEN DIRECTED. IF CONTRACTOR DETERMINES THAT THERE IS NO CONFLICT WITH EXISTING UTILITIES, THEN CONTRACTOR SHALL PROVIDE NOTARIZED AFFIDAVIT PRIOR TO CONSTRUCTION TO THE ENGINEER STATING THAT HE HAS VERIFIED THE HORIZONTAL AND VERTICAL LOCATION OF ALL EXISTING UTILITIES AND THAT THERE ARE NO CONFLICTS WITH THE PROPOSED IMPROVEMENTS, PRIOR TO SUBMITTING ANY SHOP DRAWINGS. THIS WORK BY THE CONTRACTOR SHALL BE CONSIDERED INCIDENTAL TO THE WORK AND NO ADDITIONAL COMPENSATION SHALL BE ALLOWED.
- CONTRACTOR SHALL COMPLY WITH ALL CONTRACT REQUIREMENTS OF THE "CIVIL ENGINEERING SPECIFICATIONS SHEET" WHICH ARE PART OF THESE CIVIL ENGINEERING PLANS. NO EXCEPTION ALLOWED WHEN BIDDING AND/OR DURING CONSTRUCTION. SPECIFICATIONS MAY EVOLVE DURING PERMITTING, AND CONTRACTOR SHALL MEET ALL OF THEM WITHOUT EXCEPTION.
- CONTRACTOR TO COORDINATE RELOCATION/HOLDING OF EXISTING UTILITIES AND/OR UTILITY POLES AT HIS OWN COST. VEGETATION, MUCK AND ANY DELETERIOUS MATERIAL UNDER PROPOSED UTILITIES AND PAVEMENT MUST BE REMOVED AND REPLACED WITH CLEAN FILL MATERIAL, FREE OF STUMPS, LARGE ROOTS OR OTHER MATTER NOT SUITABLE FOR INCLUSION IN ROADWAY FILL. REMOVE ALL MUCK UNDER PARKING LOT.
- ALL WATER MAINS SHALL BE PVC C-900(UNLESS OTHERWISE NOTED) AND RESTRAINED WITH MEGALUGS OR APPROVED EQUAL.
- ALL WATER METERS SHALL HAVE A BACKFLOW PREVENTOR AS SIZED BY MEP AND CITY OF POMPANO BEACH SPECIFICATIONS.
- ALL SEWER SERVICE SHALL BE 6" PVC SDR 35 MINIMUM OR GREATER AS SHOWN ON PLANS.
- ALL BACKFLOW PREVENTION DEVICES TO BE CERTIFIED PRIOR TO ISSUANCE OF FINAL CO.
- PROVIDE MINIMUM 36" OF COVER FOR PVC MAINS, AND 30" OF COVER FOR DIP MAINS.
- SANITARY SEWER LATERALS ARE DIAGRAMMATIC AND INDICATE THE GENERAL ARRANGEMENT OF SYSTEMS AND WORK INDICATED TO MEET AND CONNECT TO THE SANITARY SEWER LATERALS FROM THE MEP ENGINEER'S PLANS. CONTRACTOR SHALL COORDINATE WITH MEP PLANS AND PLUMBER TO PROVIDE A COMPLETE WORKING SYSTEM. CONSULT THE MEP PLANS AND CIVIL ENGINEER FOR EXACT LOCATIONS OF ITEMS WHICH ARE NOT DEFINITELY LOCATED ON THE DRAWINGS.
- ALL CLEAN-OUTS ARE 2-WAY CLEAN-OUTS.
- THESE CIVIL ENGINEERING PLANS ARE FOR PAVING, STORM DRAINAGE, GRADING, WATER, AND SANITARY SEWER, AND RELATED CIVIL ENGINEERING DETAILS ONLY. FOR EXACT LAY-OUT, SETBACKS, ZONING INFORMATION, ETC., SEE PLANS PREPARED BY THE ARCHITECT.
- UNUTILIZED WATER AND/OR SEWER SERVICE TO THE PARCEL SHALL BE ABANDONED ACCORDING TO CITY SPECIFICATION.
- LANDSCAPING MATERIALS OTHER THAN SOD ARE NOT ALLOWED WITHIN (5') FIVE FEET OF ANY PORTION OF CITY OWNED UTILITIES WITHIN THE PUBLIC STREET RIGHT-OF-WAY INCLUDING METERS, HYDRANTS, SERVICE LINES ETC. SHOW THE LOCATION OF ALL EXISTING CITY OWNED AND MAINTAINED POTABLE WATER MAINS AND SERVICES, SANITARY SEWER MAINS OR LATERALS AND STORM DRAINAGE LINES ON THE PROPOSED LANDSCAPE PLANS.
- ANY EXISTING WATER AND/OR SEWER CONNECTIONS TO THE SUBJECT LOTS NOT UTILIZED MUST ALL BE CUT AND CAPPED AT THE WATER MAIN IF A WATER SERVICE AND CUT OUT AND SLEEVED IF A SEWER LATERAL. HOW TO RETIRE OLD LATERALS:
  - IF THE EXISTING MAIN IS CLAY PIPE AND HAS A CIPP LINER CURRENTLY INSTALLED. (INSTALL A SECTIONAL LINER IN THE MAIN OVER THE OLD LATERAL THUS ELIMINATING THE LATERAL).
  - IF THE EXISTING MAIN IS CLAY PIPE. (DIG DOWN, CUT OLD CLAY PIPE, SLEEVE BACK IN WITH PVC AND CITY APPROVED COUPLINGS)
  - IF THE EXISTING MAIN IS CLAY PIPE AND YOU ARE REQUIRED TO RETIRE MULTIPLE LATERALS FOR A PROJECT (IT MAY BE CHEAPER FOR THE CONTRACTOR TO INSTALL A CITY APPROVED CIPP LINER FROM MANHOLE TO MANHOLE AND NOT CUT OUT THE LATERALS THAT THEY ARE RETIRING)
  - IF THE EXISTING MAIN IS PVC PIPE. (REMOVE THE LATERAL PIPE FROM THE PVC WYE FITTING AND INSTALL A PLUG INTO THE WYE. INSTALL A GREEN LOCATING MARKING BALL AT THE LATERAL. LOCATING NO DEEPER THAN 4 FT BELOW GRADE).
- ANY EXISTING WATER AND/OR SEWER CONNECTION TO THE SUBJECT LOTS NOT UTILIZED MUST BE CUT AND CAPPED AT THE WATER MAIN IF A WATER SERVICE AND CUT OUT AND SLEEVED IF A SEWER LATERAL. SEWER LATERALS THAT ARE CUT AND CAPPED WILL NEED TO BE AS-BUILT PER OUR ENGINEERING AS-BUILT STANDARDS.
- CIVIL PLANS THAT THE EXISTING ROADWAY WITHIN THE PROJECT LIMITS AND POSSIBLE BEYOND WILL BE INSPECTED BY THE CITY ENGINEER, PUBLIC WORKS DIRECTOR OR A DESIGNATED REPRESENTATIVE FOR DAMAGE DUE TO CONSTRUCTION PRIOR TO FINAL ACCEPTANCE. A PARTIAL OR FULL MILLING AND OVERLAY OF THE ROADWAYS MAY BE REQUIRED.

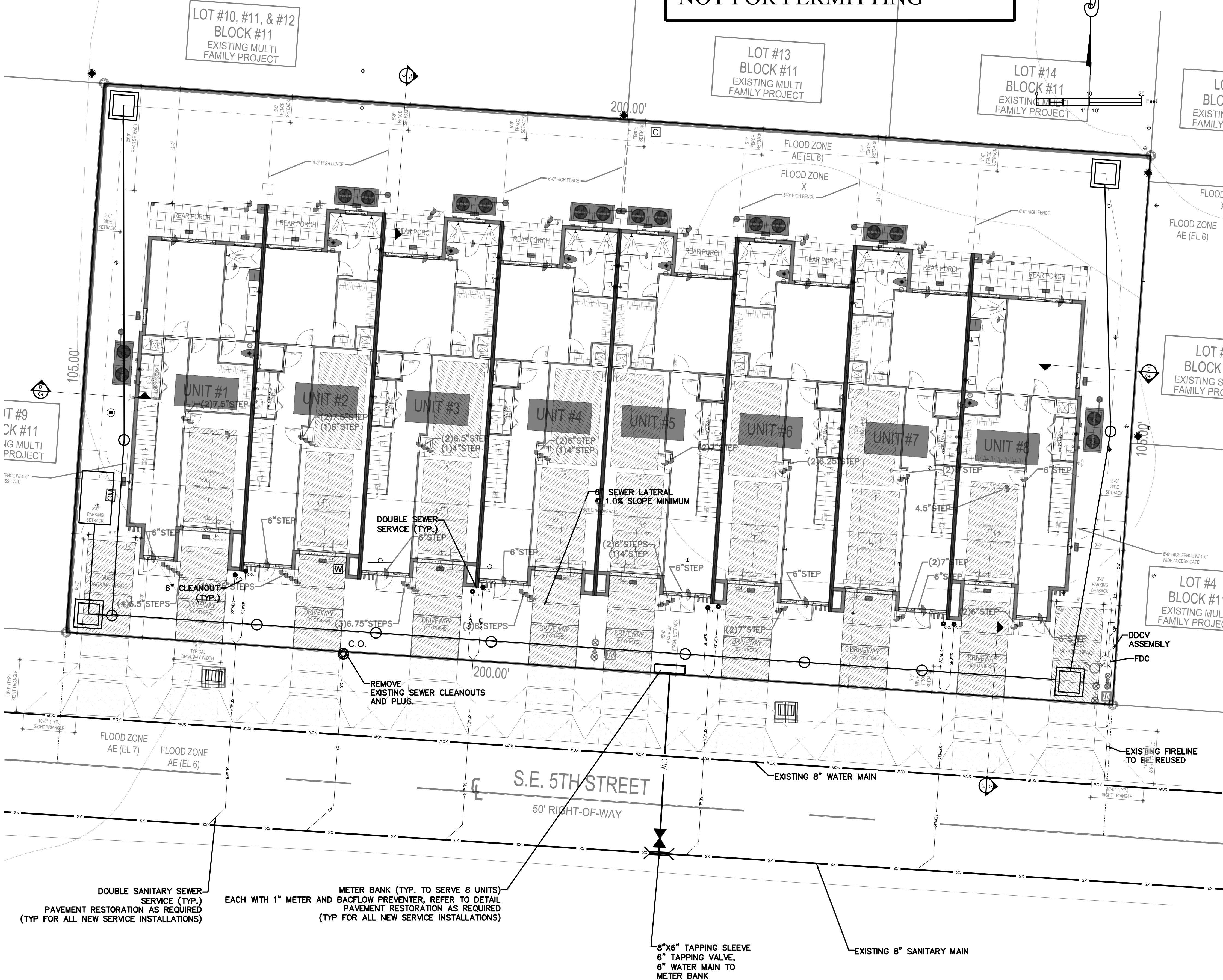

PERMITTING AGENCIES	APPROVED	PERMIT NO.	EXPIRES
CITY OF POMPANO BEACH			
IF ALL OF THE ABOVE INFORMATION HAS NOT BEEN PROVIDED, THIS SET OF DRAWINGS SHOULD BE USED AS A PERMIT SET ONLY, NOT FOR BID AND NOT FOR CONSTRUCTION. THE CONTRACTOR SHALL BE RESPONSIBLE FOR NOT LETTING ANY PERMIT EXPIRE. THE CONTRACTOR SHALL BE RESPONSIBLE FOR COMPLYING WITH ALL PERMIT CONDITIONS.			

ATTENTION IS DIRECTED TO THE FACT THAT THESE PLANS MAY HAVE BEEN REDUCED IN SIZE BY REPRODUCTION. THIS MUST BE CONSIDERED WHEN OBTAINING SCALED DATA.

Sunshine811

Call 811 or www.sunshine811.com two full business days before digging to have utilities located and marked.

REPRODUCTION AND USE OF THESE DOCUMENTS OR REPRODUCTION AND REPRODUCTION OF SERVICE AND SHALL REMAIN THE PROPERTY OF GLOBE ENGINEERING, INC. WITHOUT THE WRITTEN PERMISSION OF GLOBE ENGINEERING, INC. THESE DOCUMENTS, DETAILS, AND SPECIFICATIONS SHALL NOT BE USED BY ANYONE, IN ANY MANNER, WITHOUT THE WRITTEN PERMISSION OF GLOBE ENGINEERING, INC. THESE PLANS MAY NOT BE REPRODUCED WITHOUT WRITTEN PERMISSION FROM GLOBE ENGINEERING, INC.

## TOWNHOMES

3305 SE 5TH STREET  
POMPANO BEACH, FL 33062

CONCEPTUAL WATER AND SEWER PLAN

## Globe Engineering, Inc.

Civil Engineering - Land Planning - Construction Management

4839 SW 148 Avenue, Suite 507  
Fort Lauderdale, FL 33330

Phone: 954-316-7628  
www.civil-engineer.us

FBPP REGISTRY No. 8604

THIS ITEM HAS BEEN DIGITALLY SIGNED AND SEALED BY MARTIN PILOTE USING A DIGITAL SIGNATURE AND DATE. PRINTED COPIES OF THIS DOCUMENT ARE NOT CONSIDERED SIGNED AND SEALED AND THE SIGNATURE MUST BE VERIFIED ON ANY ELECTRONIC COPIES. PRINTED COPIES ARE ONLY VALID IF IT INCLUDES AN INK ORIGINAL HAND SIGNATURE.

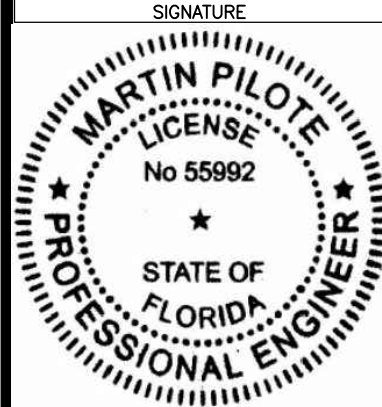

DESIGNED: MP  
DRAWN: SKC  
PROJECT NO: 2025-011  
DRAWING NAME: C-2  
SHEET NO: C-2 OF 7